

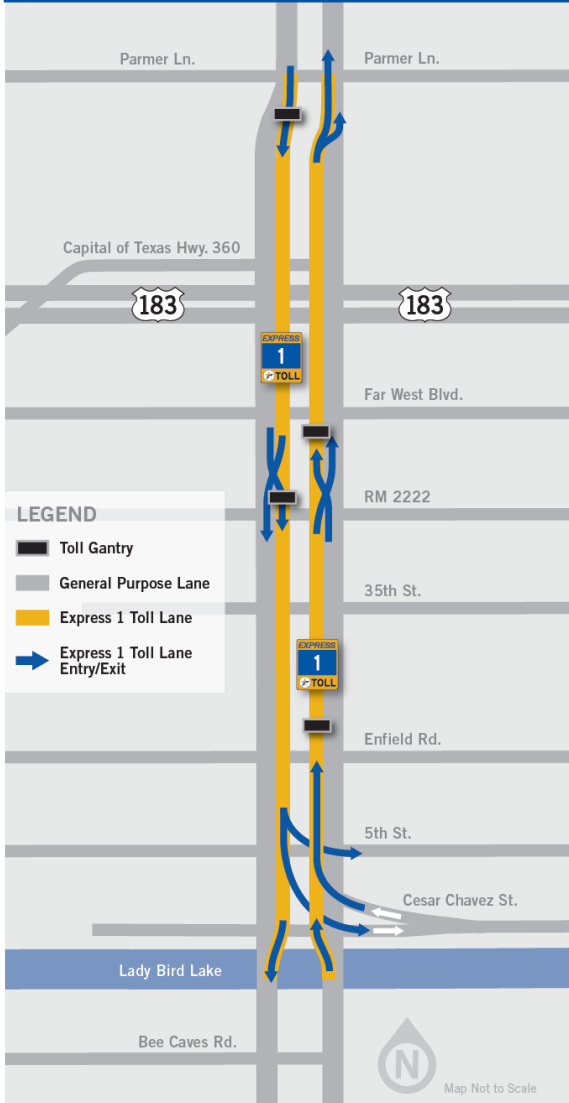

# MOPAC EXPRESS LANE FACT SHEET

## MOPAC EXPRESS LANE ENTRANCE AND EXIT MAP



### EXPRESS LANE ENTRANCE AND EXIT LOCATIONS

**NORTH:** near Parmer Lane

**CENTRAL:** between Far West Boulevard  
and RM 2222

**SOUTH:** near Cesar Chavez Street and  
5th Street

## OVERVIEW

The MoPac Express Lane will give drivers the option to bypass congestion on the 11-mile stretch of MoPac between Parmer Lane and Cesar Chavez Street. Those who prefer not to pay a toll can use the non-tolled lanes on MoPac.

## PROJECT DESCRIPTION

The MoPac Express Lanes are special buffer-separated lanes that use variable tolls to keep traffic moving even when the adjacent lanes are congested. This is accomplished by raising the toll when traffic is heavy and lowering the toll when traffic is light, leveraging supply and demand principles to ensure drivers have a reliable, congestion-free route to their destination. The Express Lane is located in the middle of the MoPac corridor, separated from the existing general purpose lanes by a four- to five-foot-wide striped buffer zone with flexible plastic delineator sticks.

## VARIABLE TOLL PRICING

To manage the number of cars in the Express Lane at any given time, variable toll pricing is used. When traffic is heavy and demand is high, toll rates increase. When demand is low, toll rates decrease. Higher rates manage congestion by discouraging drivers to enter the lanes and ensure a reliable trip for drivers when they need it. Public transit buses, registered van pools and first responders ride toll-free in the Express Lane.

The northbound, north end Express Lane segment is open to traffic between RM 2222 and Parmer Lane as of October 15, 2016. The northbound south end segment as well as both southbound segments will open to traffic in 2017.



CENTRAL TEXAS REGIONAL  
MOBILITY AUTHORITY



# MOPAC EXPRESS LANE FACT SHEET

## LANE ACCESS

Drivers will be able to access the Express Lane at Cesar Chavez Street, RM 2222 or Parmer Lane. Because Express Lane access is available through the inner-most general purpose lane, many drivers will continue to use the same MoPac entrances and exits as they do today. For example, drivers exiting the Domain area (just east of MoPac between Parmer Lane and Braker Lane) who want to use the southbound Express Lane to access downtown Austin will complete the following movements:

- ▶ Enter the southbound general purpose lanes using the existing entrance at Braker Lane; merge into the outer-most general purpose lane
- ▶ As you travel, safely change lanes until you are traveling in the inner-most general purpose lane
- ▶ As you approach Far West Boulevard, a sign will display the toll rates in real time; you'll know how much your trip will cost based on the price displayed next to the "to 5th, Cesar Chavez St." destination.
- ▶ Between Far West Boulevard and RM 2222, you'll merge into the Express Lane from the inner-most general purpose lane through a break in the striping and white plastic delineator sticks, indicated by overhead signs. As you pass Enfield Road, you'll approach the Express Lane flyover to 5th Street/Cesar Chavez Street.
- ▶ You'll access the flyover through another break in the striping and plastic delineator sticks, indicated by overhead signs.

## Reading Express Lane Toll Pricing Signage

### EXPRESS LANE PRICING:

Changeable electronic signs display the current toll rates in real time, so you'll know the price before you decide whether to enter the lane. Once you are in the lane, the price you saw is the price you'll pay.

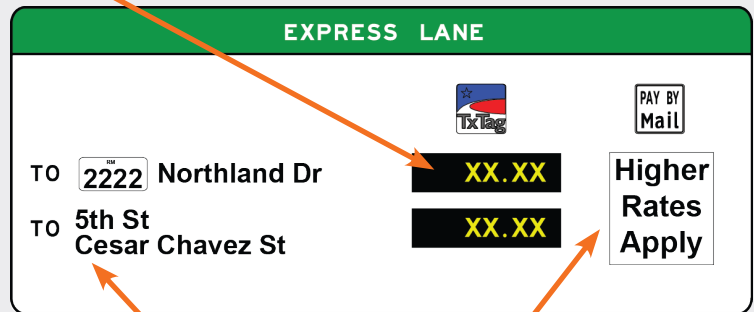

### DESTINATION EXIT:

The project is divided into two segments, each with a corresponding toll price. As shown above, when you enter the southbound Express Lane near Parmer Lane, you'll determine which Express Lane exit will provide access to your destination and the cost you'll pay to drive to that exit.

### PAY BY MAIL OPTION:

Drivers without a TxTag, Toll Tag or EzTag will have their license plate photographed and the vehicle owner will be mailed a bill with a 33% higher toll rate and an additional \$1.00 fee per invoice to cover the higher cost of processing.

## PAYMENT OPTIONS



### TOLL TAG

Pay your tolls with a TxTag, TollTag or EZ TAG and get a 25% discount. TxTag is operated by TxDOT and is available online at [www.TxTag.org](http://www.TxTag.org), or by calling 1-888-Go-TxTag.



### PAY BY MAIL

If you don't have a tag just keep moving, and we'll bill you through the Pay By Mail program. Pay By Mail customers are billed using a picture of their license plate, and are charged a \$1.00 statement fee per bill.

Pay by Mail is available online at [www.paytextastoll.com](http://www.paytextastoll.com), or by calling 1-888-811-4565.